

# Maiden Bradley

Parish News

No 351 September 2018



**Phoebe Cross - Winner of the Children's Shield  
in this year's Produce Show**

# 2018 Produce Show - Winners

**Points winners -**  
Rosie Brown (36) and Dave Crossman (66)

**Children's Shield -**  
Phoebe Cross



**Best Village Dog -**

Sammy - with Robyn Allard



**Pete Dean Cup -**  
Rosie Brown

**Margaret Smith Rose Bowl for  
best August Garden -**  
Sue Loudon

**See centre pages  
for more photos and inside  
back cover for full results**



## Diary September

2 <sup>nd</sup>	Sun	Catch Up Sunday with Coffee & Croissants – Memorial Hall	10.00 am
3 <sup>rd</sup>	Mon	Household Waste Collection	7.00 am
		Book Group – 1, Castle Hill Lane, Mere	8.00 pm
5 <sup>th</sup>	Wed	Prayer Meeting	6.30 pm
9 <sup>th</sup>	Sun	Matins – Church	10.00 am
10 <sup>th</sup>	Mon	Black Box, Blue & Green Bins Collection	7.00 am
		Memorial Hall A.G.M. – Memorial Hall	7.00 pm
11 <sup>th</sup>	Tue	Parish Council Meeting – Memorial Hall	7.30 pm
12 <sup>th</sup>	Wed	Prayer Meeting	6.30 pm
16 <sup>th</sup>	Sun	Communion – Church	10.00 am
17 <sup>th</sup>	Mon	Household Waste Collection	7.00 am
19 <sup>th</sup>	Wed	Prayer Meeting	6.30 pm
20 <sup>th</sup>	<b>Copy Deadline for October Parish News to <a href="mailto:pat@visa-office.com">pat@visa-office.com</a></b>		
20 <sup>th</sup>	Thu	Welcome Club Quiz – Horningsham Hall	2.30 pm
22 <sup>nd</sup>	Sat	Flower Festival – Bradley House	
		Flower Festival Service_Bradley House	5.00 pm
23 <sup>rd</sup>	Sun	Flower Festival – Bradley House	
24 <sup>th</sup>	Mon	Black Box, Green & Blue Bins Collection	7.00 am
25 <sup>th</sup>	Tue	Welcome Club Outing to Sidmouth	9.00 am
26 <sup>th</sup>	Wed	Prayer Meeting	6.30 pm
28 <sup>th</sup>	Fri	Macmillan Coffee Morning – Memorial Hall	
		Quiz Night _Memorial Hall	7.30 pm
30 <sup>th</sup>	Sun	Benifice Service at St Michael’s, Mere	10.30 am
		No Service at All Saints’	

### October

1 <sup>st</sup>	Mon	Household Waste	7.00 am
12 <sup>th</sup>	Fri	Harvest Festival Supper – Manor Farm	7.00 pm
Mass times:-		St.George’s, Warminster – Saturday 6 pm (Vigil); Sunday 8 am 10 am St. Mary’s, Mere – Friday 10 am; Saturday 5.30 pm	

Dr Harding’s Surgery every Monday at the Memorial Hall except Bank Holidays 5-6 pm. Please bring your orders to Memorial Hall Surgery the week before they are due for the Doctor to process..

Refuse & Recycling Collections every Monday, for Bank Holiday changes see Wiltshire Council website.

Mother & Toddlers every Tuesday 10.00 am to 12 noon.

Useful telephone Nos.: The Pub: 844207; Memorial Hall bookings – Mel Thomas 845111 ; Dr. Andrew Murrison MP: 01225 358584 or [murrisona@parliament.uk](mailto:murrisona@parliament.uk); Mere Link Scheme 01747 860096; Rev. Carol Wilson-Barker 01747 861859.

Bell Ringing every Tuesday 7 pm in the Bell Tower at the Church. Beginners welcome 844475

Coffee Mornings every Friday in the Hall 10 am till 12 noon

Maiden Bradley Parish News – contributions are welcome and preferred in WORD format. Email [pat@visa-office.com](mailto:pat@visa-office.com)

**Magazine available online at  
[www.maidenbradleyvillage.org.uk](http://www.maidenbradleyvillage.org.uk)**



**We have just learnt that the Big Lottery Grant application for improvements to the Village Hall has been approved. No further information at present but a full report will appear in next month's News.**

## Editorial

Warmest congratulations to Sue and John Priestner for their magnificent Produce Show held in the Village Hall on 18<sup>th</sup> August. The villagers supported the event with copious quantities of very interesting artwork, floral exhibits, photographs, cakes, biscuits, preserves and vegetables. There was a tombola and raffle with cream teas served in the kitchen. Congratulations also to those whose exhibits won prizes, a successful event all-round.

Let us not forget the very successful History Festival organised by the Gunstone Family, I am already looking forward to attending next year's event.

The talents and interests of the villagers of Maiden Bradley and surrounding area continues and we have a very important "Save the Date" notice:

A village Harvest Festival Supper on 12<sup>th</sup> October at Manor Farm at 7pm. An event for all the family. More details will follow on News website, posters and in next month's Parish News.

Back to School time again and I suspect many will actually be looking forward to a more structured existence after the long summer break. My four year old grandson goes to big school for the first time this September and I wish him and all those returning to school, a very successful term.

Hopefully, this week sometime, I will be cutting back the overhang from my front garden wall as since the rain came, the foliage has put on a growth spurt. Perhaps you could do the same, if you need to! **Pat Kennedy 845397 pat@visa-office.com**

### Sarah Jefferies

As many of you will know our wonderful, and hard working Parish Clerk, Sarah Jefferies, was taken into hospital recently with a bleed on the brain. She has now come home but will need some considerable amount of time to recuperate. We at the Parish Council, and I am sure the whole of the village, wishes her the speediest of recoveries and wants to let her now that we are all thinking of her.

Sarah Jefferies will be off for some time so I wanted to let Parishioners know that if they need some urgent action taken by the council they should get in contact with one of the Councillors.

**Angus Neish (Chairman Maiden Bradley Parish Council)**

## August News From The Hall

August started off with a new event organised and run by Ben and Tonia Gunstone and their girls, and they brought us The History Festival. Both nights were well supported and money was raised for the Hall, The Stars appeal and Leukaemia Care. Well done the Gunstones, Wendy and Shelia for all the effort put into it.

The Old Kitchen store is going from strength to strength, with help from the village's gardeners we now have fresh veg available. The shop managers Brenda & Shelia seem to expand the range of goods on offer as each week passes.

Due to a very large donation of books the library is well stocked and if you are looking for a good read to curl up with, come and give it a visit during shop opening hours.

Two new events that are being looked into are a Board Game afternoon and for the younger generation is a Large Screen Gaming event, any feed back on both, is most welcome, speak to Shelia Foley.

**The hall AGM is on Monday 10<sup>th</sup> of September, if you wish to be part of the Hall's Management Committee please contact Mel Thomas or Shelia Foley by the Friday 7<sup>th</sup> September. If you would like to be involved in the running of the hall please, please let us know.**

On Friday 28<sup>th</sup> September we are holding the Macmillan Coffee Morning and trust we will have a big turnout. Macmillan nurses help those suffering with a form of cancer, cope with the changes the illness can bring to the patient and the whole family. Worthy of everyone's support.

October Film Night Friday 5<sup>th</sup> 7 for 7.30pm "Finding your feet" starring Celia Imrie, Timothy Spall, Imelda Staunton, David Hayman, John Sessions and Joanna Lumley.



A Big thank you goes to Sue & John Priestner and their team of helpers in making The Produce Show a great success, once again, also a big pat on the back to all of you who supported the show.

**"Well Done All"**

Don't forget the "Pit stop café" is once again open on Sunday mornings, give it a try for a great Bacon Or Sausage roll + Tea/Coffee for just £3.00.

Mel Thomas

# Maiden Bradley Community Social Media



Thank you to those that have already joined the Maiden Bradley Village News Group and “liked” the Page of the same name. Over the last few months we have slowly been trying to build up a following and as of this morning we have 250 people in the Group of local people who share our interest in the village and most importantly the activities and events.

If you have not already joined up please look for the Maiden Bradley Village News Group and ask to join – we will endeavour to promote as much as possible through this Group so you can keep up to date with everything that is going on in our village not only at the Village Hall but also The Somerset Arms and any other local events.

Please encourage your friends and family to join up to and help us to promote events by sharing any postings that you think might be relevant and if you have anything you wish to share that is relevant please do so. If you need any help or have any queries please email me on [maidenbradleynews@gmail.com](mailto:maidenbradleynews@gmail.com)

***Lucinda Stokes***

## **Quiz Night**

**On Friday 28th September at 7.30pm in the village hall we are holding another Quiz Night. Teams of up to 6 players, £3 per person.**

**Hope to see you there.**

**Pam Thomlinson**

## Welcome Club

Chris Short 01985 847373

For our July meeting we heard of the Aster Group, three ladies spoke of homes being given changes to make living easier as required by those people who would benefit, usually the elderly and/or disabled, bathrooms, rails, chair lifts etc. All at a cost!

The July trip was to Corfe and Swanage. We stopped at the Compton Abbas Airfield for coffee, a wonderful spot and then on to Corfe for some who took the steam train on to Swanage, later to meet up with the rest who had gone straight there by coach. Lovely weather again and a good time was had by all. The usual raffle on the way home.

Now for September! There will be a Quiz on September 20<sup>th</sup> and a trip to Sidmouth on September 25<sup>th</sup>. Please let me know if you are coming on the trip if you haven't already done so. Thanks!



The two children in this photo as featured in the July News are Reg and Ruth Prowse. Ruth became Ruth Downes.

### Village Hall Lottery

July				
1 <sup>st</sup>	Darren Knight	£25.50	2 <sup>nd</sup> Tonia Gunstone	£12.75
3 <sup>rd</sup>	Cas Gunter	£7.70	4 <sup>th</sup> Jo Betts	£5.05
August				
1 <sup>st</sup>	Dave Francis	£25.50	2 <sup>nd</sup> Graham Stevens	£12.75
3 <sup>rd</sup>	Vicki Olding	£7.70	4 <sup>th</sup> C. Crabbe	£5.05

Since 1998 the lottery has brought in a total of £21191.25 to help maintain the village hall. Therefore £10595.62 has gone to the village hall and the same amount in prize money up to last December.

If you would like to help support your Village Hall, please get in contact with John Priestner on 844244 who has some spare numbers. Only 50p per number per month, you can have more than one number. Half the draw's income goes to the Village Hall and half goes in prizes.

## MY FAMILY INTEREST IN THE VILLAGE OF THE PAST

For many years I have been reading the Maiden Bradley Village Magazine, first by post and now on-line, as one branch of my family named Snook lived in the village in days gone by. It was a pity I could not attend your recent History Festival held at the end of July, but as I live in West Sussex that wasn't possible.

I would be interested to know if anyone living in Maiden Bradley today have ancestors going back to James Snook, who was baptised in 1808 and married first Charlotte (nee Newbury) and then Emma (nee White). James Snook Snr had a son James who was born in 1848 in the village and 'married' my Great Great Grandmother Eliza (nee Moon). Their marriage has never been found but they went on to have a large family including my great grandfather Charles who was born to Eliza before she married James.

It seems to be a complicated family with different stories attached to them. James Snook Jnr died in 1901 in Frome Workhouse, but I have never found Eliza's death or burial. According to the 1901 census James was a widower, but an elderly relative, now deceased herself, once said she visited Eliza Snook, when she was a teenager, in the village, but that would have been in the early 20<sup>th</sup> century, certainly after 1901.

Does anyone have the mysterious Eliza in their family? I have taken my Snook family back to the earliest known record that being Philip Snook who was born c1762 and died in 1841. If anyone would like to shed any information on the above my e-mail address is: [Valerie.dare@ntlworld.com](mailto:Valerie.dare@ntlworld.com)

Thank you. Valerie Boddy



**Downlands**  
TREE SURGERY

01985 214320

95 Frome Road  
Maiden Bradley, BA12 7JA

Expert Tree Care  
Skilled Pruning  
Felling  
Stump Removal  
Qualified & Insured

*Free Tree Health Survey  
And Quotes*



## Maiden Bradley History Festival: 27<sup>th</sup> and 28<sup>th</sup> July

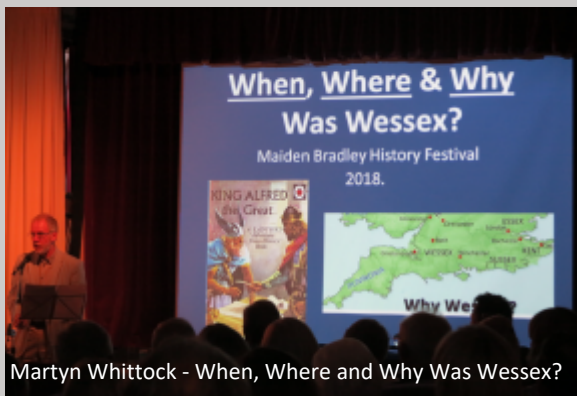

Martyn Whittock - When, Where and Why Was Wessex?



Nicki Lauder - The Ballad of Reading Abbey



Poppy Lucas-Phillips: A Brief History of Maiden Bradley

Thank you to everybody who supported the first Maiden Bradley History Festival. Together, we raised over £500 for the Village Hall roof fund, the Salisbury Hospital Stars Appeal for a new MRI scanner and Leukaemia Care.

Both evening events were well attended. Speakers' presentations on Friday included a road trip through Jim Mann's beautiful classic car photography, Jaz Wiseman's rough guide to the world of Lew Grade's TV world, and Tom Morgan's brilliantly crafted biography of Michael I, the last king of Romania. On Saturday, Nicki Lauder delivered an expert's view of the history and architecture of Reading Abbey; Poppy Lucas-Phillips presented a brief history of Maiden Bradley – a well-received and polished first appearance in public. Closing the festival, internationally acclaimed historian Martyn Whittock delighted the audience with When, Where and Why Was Wessex?

All being well, we hope to do something similar (and a bit more!) next year. If you would like to get involved, please get in touch via the Village Hall.

**Ben and Lila**

# The 2018 Produce Show





## Village Produce Show

Many thanks to all of you who made the show such a huge success this year, we have raised over £500 for the Memorial Hall. In particular we were thrilled to have a record number of entries and all the judges were very impressed with the high standard that Maiden Bradley can produce. Also many thanks to all those who helped stewarding with the judges, serving in the kitchen or manning the tombola and raffle.

There are also two people in particular we must thank who do jobs for the show well before the event namely Sue Loudoun who kindly writes out the prize cards and Dean Press who sponsored the show schedules. We are already looking forward to next year's show which will probably be on August 17<sup>th</sup>. If you have any ideas that you would like to run by us then please do while the show is fresh in your minds.

Sue and John Priestner.

## **FLOWER FESTIVAL BRADLEY HOUSE**

Dear parents, we would love to have your children take part in the festival. Please encourage them to bring a jam jar of flowers to Bradley House on Friday the 21st by 5.30pm, where we will place them together to make a "Children's Carpet of Flowers".

It will look amazing. Yours hopefully, the flower team.



## **Cake Donations**

We would be very appreciative of any donations of cakes for the refreshments during the festival. Could you bring them to the old stables at Bradley House where the teas will be served, or to Mary Stevens on the morning of September 22nd. Thanks for your support.

f Follow 'Fostering in Wiltshire'

## Could you offer a stable and supportive home?

We need foster carers who can provide a loving, supportive home for children in care. We will provide you with suitable placements to match your circumstances. You will be part of a professional team and be provided with your own support worker, ongoing training and a 24 hour helpline. In addition, you will be paid a generous allowance.

### Interested?

Call us today on 0800 169 6321,  
email [fostering@wiltshire.gov.uk](mailto:fostering@wiltshire.gov.uk) or  
go to [www.wiltshire.gov.uk/fostering](http://www.wiltshire.gov.uk/fostering)

*Be the difference – become a foster carer with Wiltshire Council*

**Fostering**  
be the difference

**Wiltshire Council**  
Where everybody matters

# computing@home

**Friendly local computer expert offers tuition,  
support , website creation and an  
IT Helpdesk service!**

**[www.computing-at-home.co.uk](http://www.computing-at-home.co.uk)  
01985 844637**

**CRABBE**  
& SON

H.Crabbe & Son

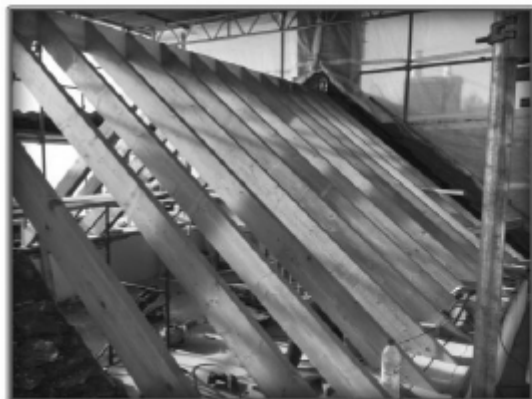

Extensions & Renovations  
Roofing  
Kitchen Fitting  
Carpentry & Joinery  
General Building and Repairs  
Painting & Decorating

Tel: 01373 832812  
Mobile: 07889140299  
markcrabbe@hotmail.co.uk

**SEASONED FIREWOOD**

**FOR SALE**

**D R M FORESTRY**

[Drmforestry@hotmail.co.uk](mailto:Drmforestry@hotmail.co.uk)



07875 350226

01985 844878

**Hard wood logs sold loose**

Price includes local delivery around Maiden Bradley and  
the local area

Various sizes available From 8 inch



Tel: 01985 845304

59 The Rank  
Maiden Bradley  
Wiltshire  
BA12 7JF  
E: [info@greenlifeplumbing.co.uk](mailto:info@greenlifeplumbing.co.uk)  
[www.greenlifeplumbing.co.uk](http://www.greenlifeplumbing.co.uk)

- Oil and Gas Boiler Installs – Boiler Finance Available
- General Plumbing Works
- Full Central Heating Systems
- Underfloor Heating
- Renewable Installs – Air Source Heat Pumps, Biomass
- 1<sup>st</sup> and 2<sup>nd</sup> Fix Plumbing Works – New Build, Extensions
- Bathroom Refurbishment, New Bathroom Projects



508089



**BAXI**  
Approved Installer

[Checkatrade.com](http://Checkatrade.com)  
Where reputation matters



## Elizabeth Gittoes

Registered  
Osteopath

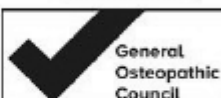

I'M REGISTERED

Registration no. 7331

[www.osteopathy.org.uk](http://www.osteopathy.org.uk)

Consultation by prior arrangement. Please call Elizabeth to make an appointment.

Email: [lizgittoes@yahoo.co.uk](mailto:lizgittoes@yahoo.co.uk)

Telephone: 01747 840496

The Old Police House  
Stourton, BA12 6QG.

## ALLSOP CARPETS & FLOORING

DOMESTIC • COMMERCIAL • INDUSTRIAL



Christchurch Street West, Frome. BA11 1EB

TEL: 01373 463866  
MOBILE: 07887 953014

[www.allsopcarpets.co.uk](http://www.allsopcarpets.co.uk)

## E G MARTIN LTD



for all your  
Central Heating Oil

01373 822784  
enquiries@egmartin.co.uk

*your local central heating  
fuel distributor*

## M H Plastering & Building Services

For a no obligation quote  
please call 01373 301009  
or 07783 226262 or email  
info@mhplasteringandbuilding.co.uk

SERVICES WE OFFER:  
Rendering • Plastering  
Floor Screeding • Dry Lining  
Stud Walls • Floor Tiling  
Wall Tiling • Brick & Block  
Work • Pointing  
And all Lime work  
for Restoration



## JERRY RAYNER:

boiler maintenance

Call 01985 841461  
or 07775 755981

For servicing and  
breakdown of oil boilers

- *Competitive rates*
- *Friendly, helpful & efficient*
- *Call now for a quote*

**Advertise  
here  
from £5 per  
month**

**Contact :  
Pat Kennedy 845397**

**pat.kennedy6093@gmail.com**



NFU MUTUAL IN  
WARMINSTER IS  
PROUD TO BE  
ASSOCIATED WITH  
MAIDEN BRADLEY  
PARISH NEWS

Taking the time to offer you attentive, personal, local service for your Insurance, pensions and investments

Call our friendly team for an  
insurance quotation on 01985  
845116 or pop in

NFU Mutual Office,  
Perry Farm,  
Maiden Bradley,  
Warminster, Wiltshire,  
BA12 7JD



**NFU Mutual**

It's about time

Agent of the National Farmers Union Mutual Insurance Society Limited.

## Painting & Decorating



By Tony Layard

Tel. 07941 759 297



MODERN FACILITIES | TRADITIONAL VALUES  
Dedicated equine, small animal & exotics team



Based in Trudoxhill, near Frome covering Somerset, Wiltshire & Dorset  
[www.bellevue-vets.co.uk](http://www.bellevue-vets.co.uk) | 01373 836186 | [info@bellevue-vets.co.uk](mailto:info@bellevue-vets.co.uk)



*"Moving at the highest standard"*

You can be sure of Armishaws:

- **UK - Local and long distance**
- Full and **part-loads**
- Full **European** service
- Full **packing** service
- **Containerised storage**
- Friendly, **personal** service
- **Local business, family owned** and run since 1973



For a survey and **FREE** same day quote please call us on:

**01985 215991**

Visit our website at: [www.armishaws.com](http://www.armishaws.com)  
or email us at [enquiries@armishaws.com](mailto:enquiries@armishaws.com)



Rural Business Services was established in 1997 to provide professional book-keeping and administration services for small to medium sized rural based businesses. In addition we offer first class Project Management, sound sensible Business Administration & Financial Solutions together with Board Level Financial Management Experience. No matter how small or big your requirement is we can tailor support to suit your business needs either on or off site.

For more information or to discuss your requirements contact  
**Lucinda Stokes on 01985 844017**  
[www.ruralaffairs.co.uk](http://www.ruralaffairs.co.uk) • email: [lucinda@ruralaffairs.co.uk](mailto:lucinda@ruralaffairs.co.uk)

## **Walking On Air Footcare**

Visiting Foot Health Professional  
MCFHP MAFHP

*Providing treatment and advice  
to keep you mobile*

**Friday Clinic held at Maiden Bradley  
Memorial Hall**

For an appointment phone Jean:

**0793 4495518**

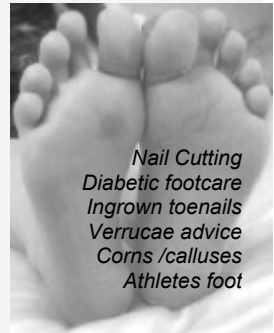

*Nail Cutting  
Diabetic footcare  
Ingrown toenails  
Verrucae advice  
Corns /calluses  
Athletes foot*

### Childrens

face mask	Georgina Higgins
book mark	Harvey Holbrook
monster	Camilla Cripps
handwriting	Charlotte Higgins
cup cakes	Hope Albert
non baked cakes	Charlotte Higgins
decorated pebble	Milly Higgins
garden tray	Camilla Cripps
picture	Milly Higgins
clay model	Camilla Cripps
waste model	Phoebe Cross
photograph	Camilla Cripps
jar of flowers	Camilla Cripps
pasta jewellery	Phoebe Plowman
decorated jar	Camilla Cripps
picture	Phoebe Cross

### Flowers

gadiolus	Dave Crossman
hydrangeas	Jenny Lucas
roses	Dave Crossman
dahlias - dec	Peter A Dean
dahlias - pom pom	Jenny Lucas
dahlias - cacti	Peter A Dean
sweet peas	Anne Seymour
mixed	Liz Nixon
5 floating flowers	Liz Nixon
fresh herbs	Liz Nixon
mixed foliage	Pat Kennedy
specimen bloom	Rosie Brown

### Cookery

savoury flan	Lisa Cripps
savoury pasty	Mel Thomas
fruit pie	Pat Kennedy
bread	Celia Bay
savoury scones	Lisa Cripps
cheese straws	Maureen Fergusso
shortbread	Gilly Hayden
Muffins	Lisa Cripps
banana cake	Di Stevens
flapjacks	Stewart Bale
lemon drizzle	Fiona Russell
victoria sandwich	Lisa Cripps
cookies	Lisa Cripps
boiled fruit cake	Di Stevens
tray bake	Esme Channer
swiss roll	Rosie Brown
men only	Martin Brown
cold dessert	Rosie Brown

### Photographs

portrait	Anne Seymour
Animals	Peter Russell
plants	Sarah Muir
insects	Peter Russell
birds	Peter Russell
patterns light	Sarah Muir
take tosokies	Peter Russell
holiday	Peter Russell
land /seascape	Peter Russell

### Vegetables and Fruit

Marrow	Rosie Brown
courgettes	Rosie Brown
runner beans	Dave Crossman
potatoes round	Dave Crossman
potatoes kidney	Peter C Dean
rhubarb	Charlotte Plowman
red onions	Dave Crossman
shalots	Dave Crossman
white onions	Dave Crossman
leeks	Dave Crossman
cucumber	Richard Cripps
carrots	Dave Crossman
Beetroot	Dave Crossman
display 3 veg	Dave Crossman
cherry toms	Rosie Brown
tomatoes	Jim Boulter
heaviest veg	Dave Crossman
longest carrot	Dave Crossman
longest rnn bean	Dave Crossman
Most amusing veg	Dave Crossman
3 diff fruits	Dave Crossman

### Preserves

soft fruit	Esther Swan
stone fruit	Anne Seymour
marmalade	Patrick Nixon
chutney / pickle	Ian Ferguson
savoury jam	James Kennedy
jelly	Rosie Brown
cordial	Martin Brown
flavoured spirit	Sally Higgins

### Flower Arrangement

foliage arrangement	Sally Higgins
nursery rhyme	Sue Priestner
candlestick	Sue Priestner
miniature	Sue Priestner

### Plants

flowering houseplant	Martin Brown
foliage plant	Sue Priestner
container of herbs	James Kennedy

## Results of the 2018 Produce Show

## Farewell to Alan and Pippa Brierly



Alan and Pippa have lived at Partridge Farm for 25 years and have been very active and supportive members of the village. They have brought up 3 children on the farm, as well as lots of sheep and horses.

Alan has been Treasurer of the Church for many years, a Volunteer in the shop and Book keeper for 5 years. Pippa has been a Bell Ringer, a Server and Flower Arranger in the church, and organised the poppy appeal for many years.

They have always turned up to village events and had lots of friends around the village. They are moving back to London and will be much missed by many in Maiden Bradley.